

M-5000TG & M-5700TG

Steam & Cold Water Mixing Hose Stations

Attain instantly hot water when and where you need it most.

These units produce instant hot water from a steady supply of steam and cold water. Both units are equipped with a dial-type gauge that indicates the wash water's exact temperature in both Celsius and Fahrenheit, and as an added safety measure, these units shut-off their steam source automatically if the cold water supply falls below 50 psi for any reason. Users can easily regulate water temperature by turning the steam and cold water valves. This prevents hazardous steam from exiting the unit and causing steam burns.

M-5000TG unit is bronze and the M-5700TG unit is stainless steel. Both stations are equipped with a stainless steel hose rack and our patented Direct Diffuse® Steam Trap. Hose and spray nozzle are sold separately.

Available options for both units are:

- Wall Mounted – globe valve or angle valve entry
- Recessed Wall Box Units – globe or angle valve entry
- Pedestal Units – globe or angle valve entry

Strahman mixing hose stations are the preferred choice by industry professionals around the globe for their exceptional durability and low maintenance, reliability in accuracy of temperature readings and function, they are economical, and they can easily be mounted anywhere in a facility where steam/water lines exist and effective clean-up is required.

Units are sold with our Direct Diffuse® Steam Trap that quickly and efficiently discharges condensate in your steam line and reduces system failure.

| MODEL NO. | REQUIRED STEAM PRESSURE | REQUIRED WATER PRESSURE | GPM |
|-----------|-------------------------|-------------------------|---------|
| M-5000L | 80-95 LBS | 50-80 LBS | 5 - 7 |
| M-5000M | 96-130 LBS | 50-80 LBS | 4 ½ - 6 |
| M-5000H | 131-150 LBS | 50-80 LBS | 4 ½ - 6 |
| M-5700L | 80-95 LBS | 50-80 LBS | 5 - 7 |
| M-5700M | 96-130 LBS | 50-80 LBS | 4 ½ - 6 |
| M-5700H | 131-150 LBS | 50-80 LBS | 4 ½ - 6 |

Note: Steam pressure is required at installation site to ensure proper operation of mixing unit.

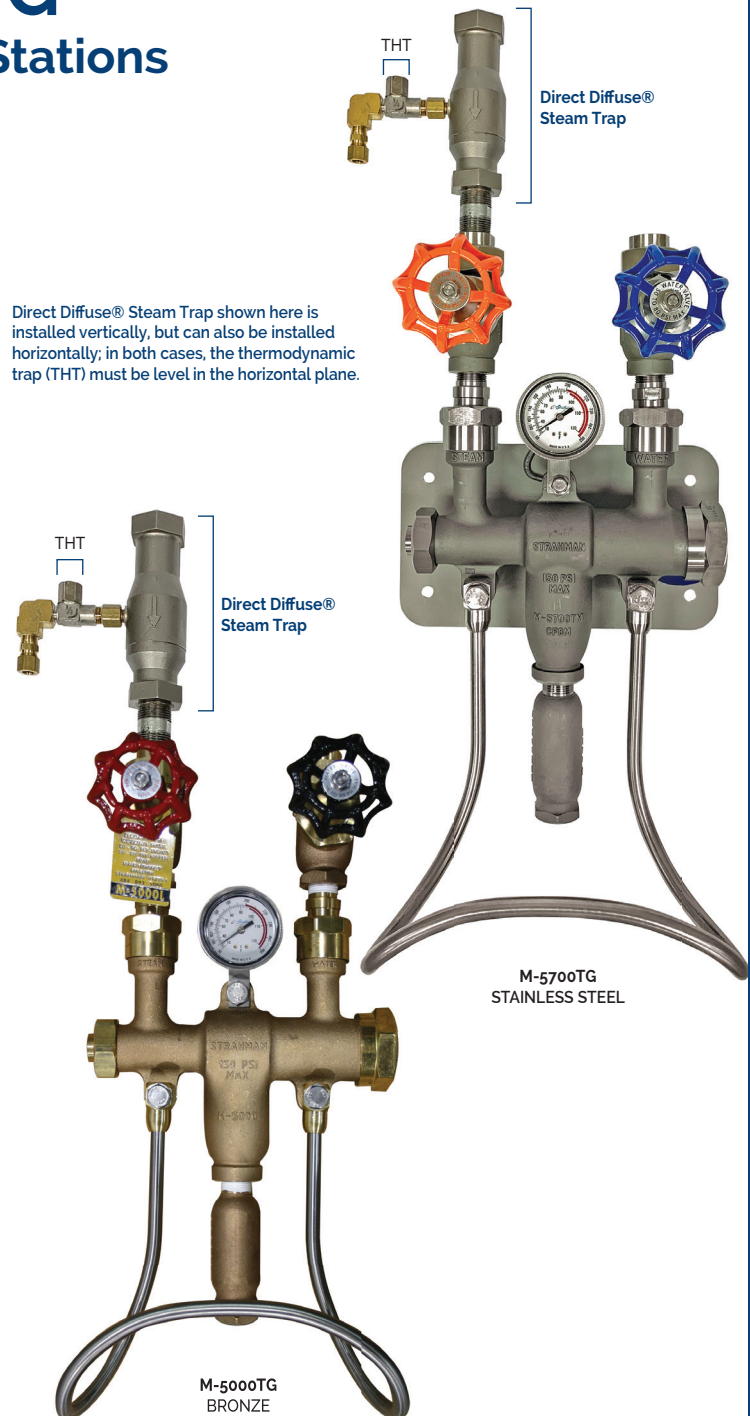

Maximum water temperature: 200°F (93°C)
Optimum working pressure range: see chart at left
(not to exceed 150 psi)

M-5000TG & M-5700TG SERIES

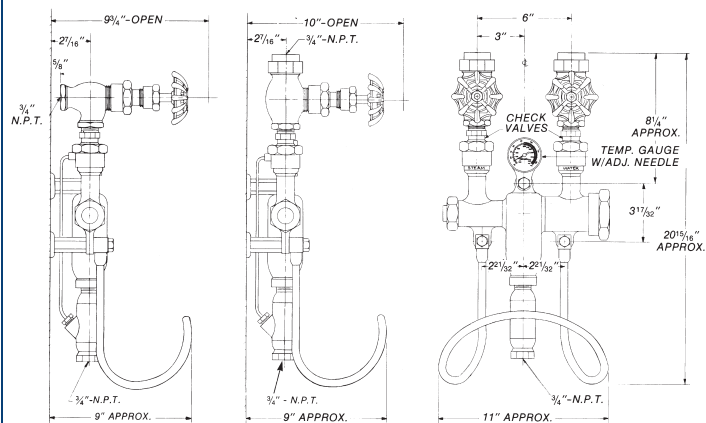
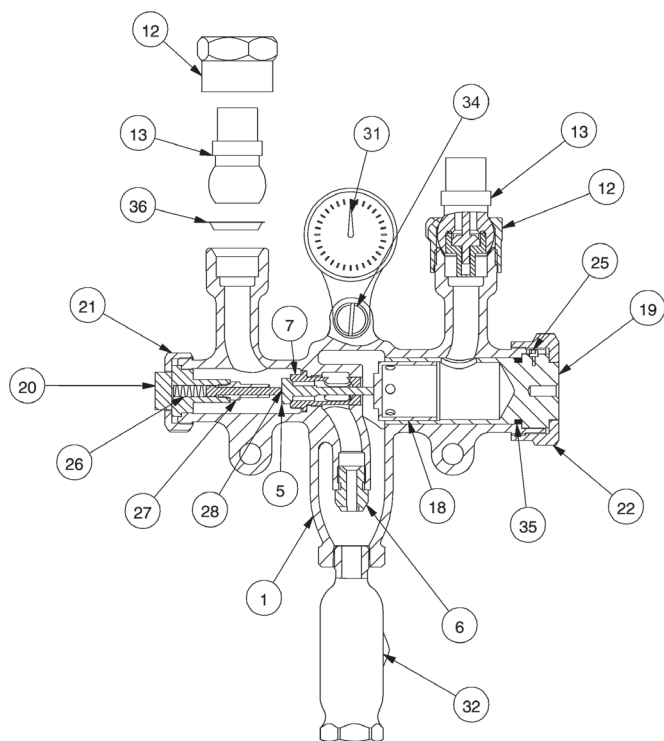

Note: Front view shown with Globe Valves.

NOTE: A strainer and steam trap is recommended to be used in conjunction with all our steam mixing units. Foreign deposits in supply lines can effect ball check durability. Proper steam and water treatment is recommended to ensure proper performance and durability. Unit should be shut-off when not in use for extended periods of time.

**Temperature Gauge: 100-250°F (40-120°C)

Published 08.30.22

| PARTS | | | |
|----------|---|--|--|
| PART NO. | PART | M-5000 ORDER NO. (MATERIAL) | M-5700 ORDER NO. (MATERIAL) |
| 1 | BODY (includes parts 6 & 7) | M500BODYKIT (ASTM CA836) | M708BDF (SST316, ASTM A314) |
| 2 | HOSE RACK CAP SCREW (not shown) (SET OF 6) | HH0050130200OZ (SST304, ASTM A276) | HH0050130200OZ (SST304, ASTM A276) |
| 3 | HOSE RACK LOCK WASHER (not shown) (SET OF 6) | WAT0050 (SST410) | WAT0050 (SST410) |
| 5 | STEAM POPPET (L) | MU500POPTCOMPLETE0000 (SST303, ASTM A743) | MU500POPTCOMPLETE0000 (SST303, ASTM A743) |
| 5 | STEAM POPPET (M) | MU500POPTCOMPLETE0001 (SST303, ASTM A743) | MU500POPTCOMPLETE0001 (SST303, ASTM A743) |
| 5 | STEAM POPPET (H) | MU500POPTCOMPLETE0002 (SST303, ASTM A743) | MU500POPTCOMPLETE0002 (SST303, ASTM A743) |
| 6 | STEAM JET | SJET (SST416, ASTM A582) | SJET (SST416, ASTM A582) |
| 7 | POPPET SEAT | PSEATBR (BRASS ASTM C46400) | PSEATSS (SST303, ASTM A582) |
| 8 | HOSE RACK (not shown) WITH FITTINGS | HRCOMPLETE0000 (SST304, ASTM A276) | HRCOMPLETE0000 (SST304, ASTM A276) |
| 10 | HEX SPACER (not shown) | MUSPAC (SST416, ASTM A582) | MUSPAC (SST416, ASTM A582) |
| 11 | WALL PLATE (not shown) (optional) | MUWPLTBR (BRASS B16, CA360) | STANDARD ON THIS UNIT (SST304, ASTM A240) |
| 12 | BALL CHECK UNION NUT | BCNUTBR (BRASS ASTM B16 C36000) | BCNUTSS (SST304, ASTM A276) |
| 13 | BALL CHECK VALVES (includes part 36) COMPLETE | BCBRG (BRASS ASTM B16, C36000, SST303, ASTM A582) | BCSSG (SST304, ASTM A276, SST303, ASTM A582) |
| 18 | WATER CHAMBER | WCHM5000 (SST303, ASTM A582) | WCHM5000 (SST303, ASTM A582) |
| 19 | WATER CHAMBER HOUSING (includes part 35) | WCHHOUSASSYBR (BRASS B16, C36000) | WCHHOUSASSYSS (SST304, ASTM A276) |
| 20 | POPPET GUIDE | M5000PGUIBR (BRASS ASTM B16, C36000, SST303, ASTM A582, EPDM "O" RING) | M570PGUI (SST304, ASTM A276, EPDM "O" RING) |
| 21 | POPPET GUIDE NUT | M500PNUTBR (BRASS B283, CA37700) | M570PNUT (SST303, ASTM A582) |
| 22 | BODY NUT | M500BNUTBR (BRASS B283, CA37700) | M570BNUT (SST316, ASTM A276) |
| 25 | SET SCREW (SET OF 6) | SHN8320031OZ (SST304, ASTM A276) | SHN8320031OZ (SST304, ASTM A276) |
| 26 | POPPET SPRING (SET OF 6) | SPRGM5000 (SST302, ASTM A240) | SPRGM5000 (SST302, ASTM A240) |
| 27 | GUIDE EXTENSION | M500PGEX (SST416, ASTM A 582) | M500PGEX (SST416, ASTM A 582) |
| 28 | PUSHER | M500PPSH (SST303, ASTM A582) | M500PPSH (SST303, ASTM A582) |
| 31** | TEMP GAUGE | TGGF02 (BRASS B283, CA37700) | TGGF02 (BRASS B283, CA37700) |
| 32 | BLENDING CHAMBER | BLCHMFB (BRASS BRONZE B62, CH83600) | BLCHMFSS (SST303, ASTM A351) |
| 35 | "O" SEALING RING FOR WATER CHAMBER HOUSING | ORNG222HB (EPDM) | ORNG222HB (EPDM) |
| 36 | BALL CHECK GASKET | BCGAC (COPPER) | BCGA (COPPER, PTFE) |



**STRAHMAN
GROUP**

PRECISION AND PERFORMANCE



www.vaportec.com.ve

USA | FRANCE | GERMANY | HONG KONG | CHINA